

A Shark Genius P4 steam mop is shown vertically against a red background. The mop has a black handle with a textured grip at the top, a long black tube, and a black body with a red stripe. The body features a control panel with a power button and a steam indicator. The base is a wide, rectangular mop head with a red, wavy, textured surface. The background is red with a white grid of dots and four white plus signs (+) arranged in a square pattern around the mop.

**Shark**

蒸汽除菌拖把快速使用指南  
QUICK START GUIDE

P4

# 内含部件

WHAT'S INSIDE

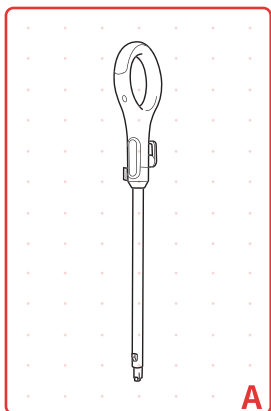

**A**

手柄

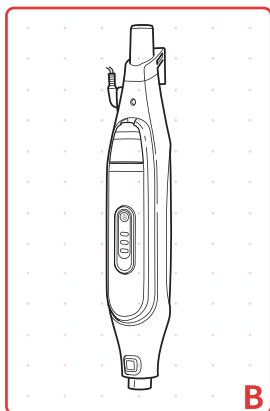

**B**

机身

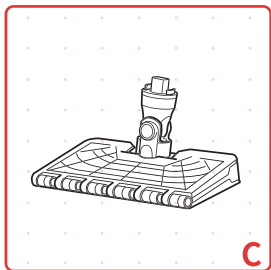

**C**

方形拖把头

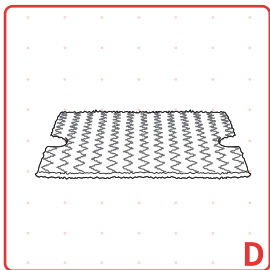

**D**

双面方形抹布 (x2)



**E**

注水杯

# 安装

ASSEMBLY

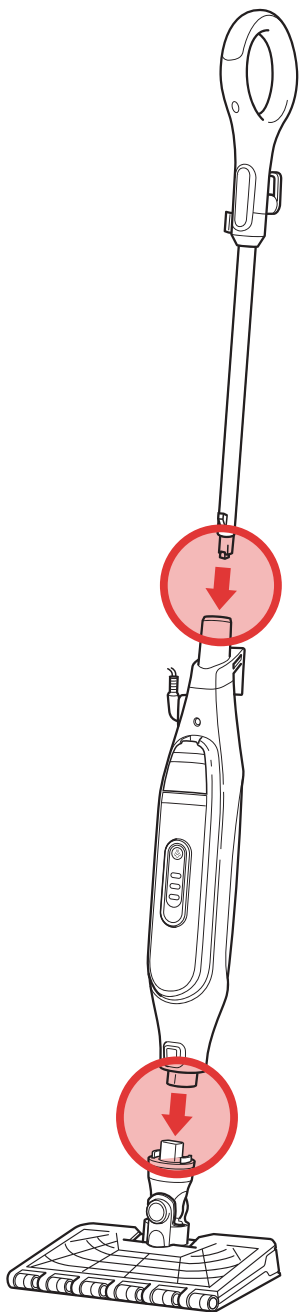

**1**  
手柄装入机身，  
直至听到“咔哒”声。

**2**  
机身装入方形拖把头，  
直至听到“咔哒”声。

### 3

#### 安装双面方形抹布\*

提起拖把头, 按机身后的释放按钮, 拖把头自动打开。

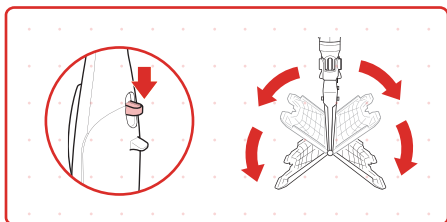

将拖把头的四个角对准抹布, 对应插入。

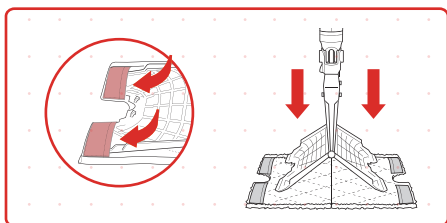

将拖把头一侧轻轻在地面上按压。

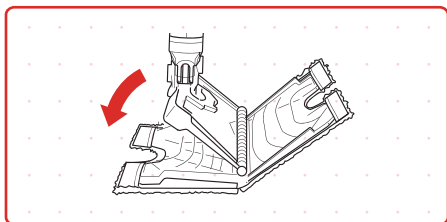

将另一面翻起来, 按压到位。

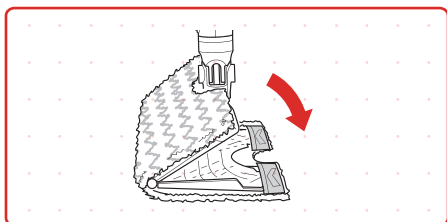

\*Shark®特有的Touch Free技术, 让您解放双手, 轻松换抹布。

# 使用

## HOW TO USE

### 1

#### 水箱加纯净水

打开水箱盖子,用注水杯向内注入纯净水,关紧盖子。  
请不要超过MAX最高水位线。

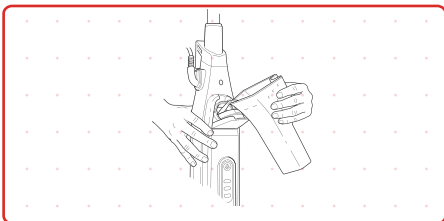

### 2 常规清洁模式

接通电源,指示灯闪烁,进入待机模式,按  键,选择适宜的档位,开始清洁。

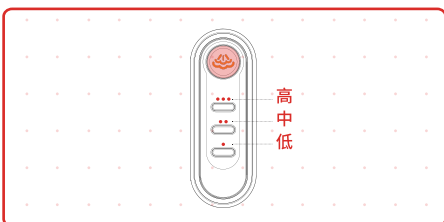

### 3

#### 强劲蒸汽模式\*

当您需要清洁顽固污垢,请使用强劲蒸汽模式。

- 翻转方形拖把头,将其放在机身后面。
- 向下倾压拖把手柄,蒸汽喷嘴可集中喷射蒸汽。
- 将拖把直立,停止蒸汽喷射。
- 将拖把头还原位置,返回常规清洁模式。

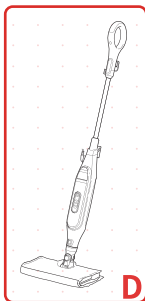
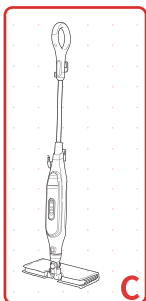
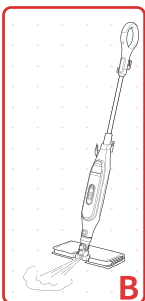
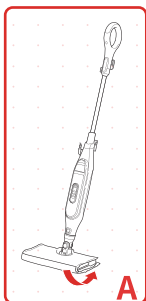

\*Shark®特有的Steam Blaster蒸汽喷射技术,集中喷射蒸汽,轻松处理顽固污垢。

## 4

### 拆卸抹布和拖把头

按机身后的释放按钮即可拆卸抹布。

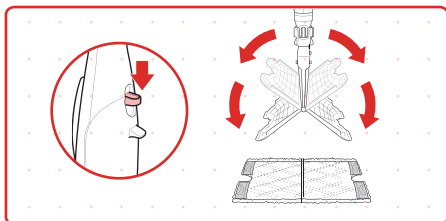

按机身底部释放按钮即可取下拖把头, 更换其他配件。

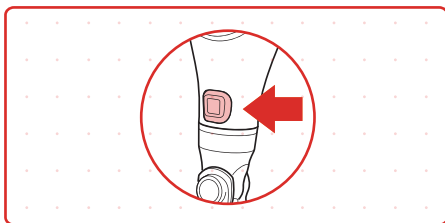

更多资讯请登录官方网站  
[www.sharkclean.com.cn](http://www.sharkclean.com.cn)  
请在使用前仔细阅读使用说明书